



St Clement

Sophie



The information contained in this brochure is for guidance only. Castletree Homes operate a policy of continuous product development and features may therefore vary from time to time. This information does not constitute a contract or warranty. All measurements and specifications are given as a guide only and may be subject to change without notice. All images are representative only, and do not necessarily reflect the development in question.

Rocque Bay

Sophiche

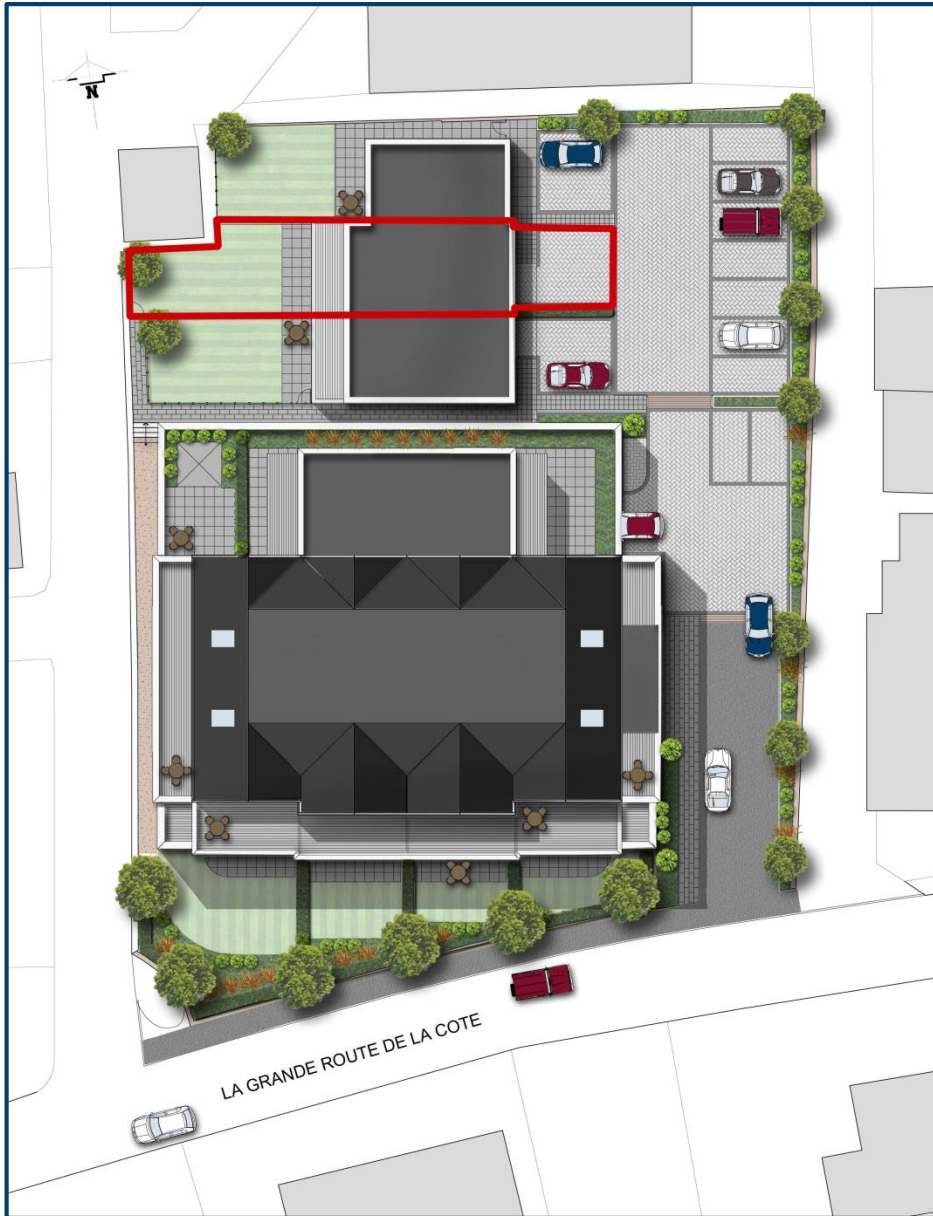

Site Layout

Sophiche

Internal Area
162.3sqm (1747 sqft)

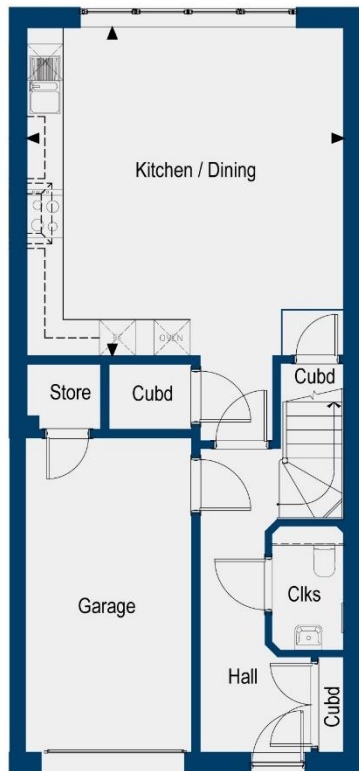

GROUND FLOOR

Kitchen/Dining

30.1sqm (323.99sqft)

5.43m x 5.24 (17'10"x17'2")

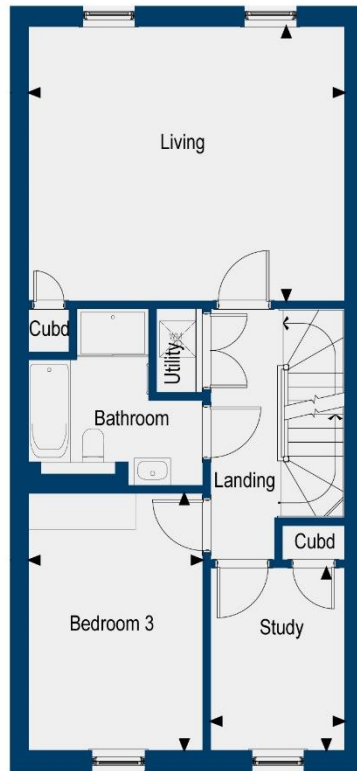

FIRST FLOOR

Living

23.8sqm (256.18sqft)

5.24m x 4.55m (17'2"x14'11")

Bedroom 3

12.3sqm (132.40sqft)

4.26m x 2.89m (14'x 9'6")

Study

6.8sqm (73.19sqm)

3.03m x 2.23m (9'10" x 7'4")

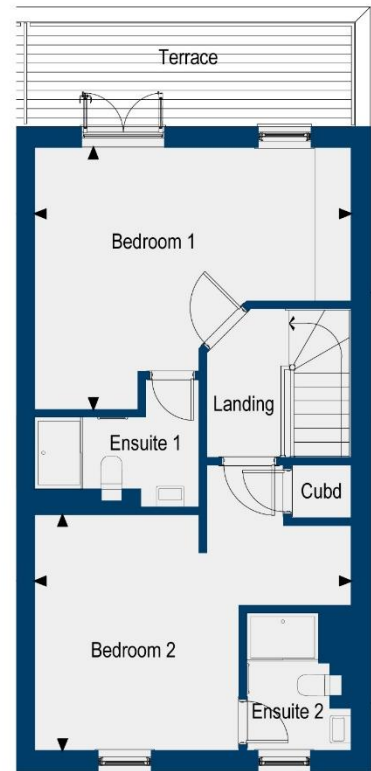

SECOND FLOOR

Bedroom 1

17.9sqm (192.67sqft)

5.24m x 4.34m (17'2"x14'3")

Bedroom 2

16.8sqm (180.83sqft)

5.24m x 3.91m (17'2"x12'10")

Fontaine, Sophiche & Roka

KITCHEN

- Luxury fitted high specification Omega kitchen from the Mackintosh range with feature under pelmet LED lighting.
 - Granite or Silestone worktop with 100mm upstand.
 - 1½ bowl under mounted stainless-steel sink with pillar chrome mixer tap.
 - A full range of Miele integrated appliances including stainless-steel double oven, microwave/oven, fridge/freezer, dishwasher, wine fridge.
 - Induction hob and extractor hood.
 - Ceramic floor tiles.
- (Appliances subject to detailed kitchen design)*

UTILITY

Fontaine

- Fitted furniture to match principal kitchen with post formed worktops and upstands. Waste and water provided for washing machine / tumble dryer space. *(No appliances provided)*
- Single, stainless steel sink with drainer and pillar tap.
- Ceramic floor tiles.

Roka and Sophiche

- Utility cupboard with waste and water provided for washing machine / tumble dryer. *(No appliances provided)*

CLOAKROOM

- White sanitaryware with chrome fittings.
- Contemporary fitted vanity furniture with storage under sink and large recessed mirror.
- Ceramic floor tiles with feature tile wall behind basin and WC.

HOUSE BATHROOM / EN-SUITES

- White sanitaryware with chrome fittings.
- Contemporary fitted vanity furniture under basin.
- Thermostatic controlled mixers to bath and adjustable rail for shower head.
- Close coupled WC with soft close seats and dual flush.
- Bath / shower screen, (if no shower in bathroom).
- En-suite, large walk in shower and thermostatic controlled mixer and fixed head.
- Ceramic floor and wall tiles with feature tile wall and recess
- Illuminated, demisting mirror cabinets to master en-suites and recessed tile mirrors to bathroom.

HEATING AND WATER

- Electric under floor heating to all habitable rooms (low-tariff E20) off individual room thermostats.
- Underfloor heating to all bathrooms off domestic supply.
- Electric thermostatically controlled towel chrome radiators to all bathrooms / en-suites.
- Electric (low-tariff E20) to hot water cylinders with secondary immersion heater. Mains pressure water.
- 1 external water tap to rear patio/gardens and also inside garage door. (Sophiche and Roka)

ELECTRICAL

- Satin stainless steel, screwless sockets with white insets throughout (white sockets in cupboards).
- External RCD socket to all patios and terraces to Sophiche and Roka.

- Wiring for Satellite (Sky+), TV & telephone points to living room, kitchen, all bedrooms and study. (Please note satellite dish not included)
- Cat 5 data cabling to all TV points to central cupboard.
- Satin stainless steel shaver sockets to bathrooms and en-suites (May be fitted in bathroom cabinet).
- Individual flush ceiling fans to bathrooms, en-suites and cloakrooms.
- Mains-operated smoke alarms / heat detectors.
- Front door bell and chime in hallway.
- Pendant light fitting with LED bulbs to living room, all bedrooms and study.
- Satin stainless steel LED downlights to bathrooms, dressing areas, cloaks, kitchen, utility, hall and landings. (Utility cupboards to have recessed white LED lights).
- Cupboards to have LED wall light on movement sensor
- Recessed LED strip lighting in bathroom / en-suites.
- Garden and terraces LED wall mounted feature lighting.
- Front door LED wall mounted coach lantern on PIR /photo cell operation.
- Garages to include double plastic socket, protected RCD and switched motor for garage door, fluorescent lighting.

FINISHES

- Windows and external doors timber pre-factory finished.
- Internal walls generally in matt emulsion except bathrooms and cloakroom.
- Bathrooms and cloakroom walls in white vinyl silk where not tiled.
- Plain ceilings finished in white matt emulsion.
- External walls painted in high quality external paint with feature bands and ashlar render defined in an alternative colour.
- Fair-faced garage blockwork walls and painted garage floor.
- Internal woodwork painted in white satin finish.
- All ironmongery to be satin stainless steel, external ironmongery pva / marine finished.

WINDOWS, DOORS & WOODWORK

- UPVC sectional retractable garage door, electric operation.
- Softwood triple glazed windows, doors and frames with softwood cills, pre-finished internally/externally with stainless steel ironmongery (marine grade)
- Georgian style half glazed hardwood entrance doors, paint grade finish
- Oak internal doors with stainless steel door furniture. Double doors to be glazed.
- Staircase: New softwood and MDF staircase , newel post, string and balustrade spindles painted. French polished oak handrail.
- Stained and polished oak carpet thresholds between habitable rooms.
- Fitted wardrobes to master bedroom only.

EXTERNAL

- Grass seeded rear garden with selected tree planting.
- Paved patio.
- Terraces to Sophiche and Roka to be composite decking boards.
- Timber close-board fence to surround gardens with lockable gates.
- Block paving to private car parking bays.
- All residents of Roque Bay will have private access to the beach via secure gated steps.

The information contained in this brochure is for guidance only. Castletree Homes operate a policy of continuous product development and features may therefore vary from time to time. This information does not constitute a contract or warranty. All measurements and specifications are given as a guide only and may be subject to change without notice. All images are representative only, and do not necessarily reflect the development in question.